

AQUATIC

IP65 PENDANT/SURFACE MOUNTED DOWNLIGHT



SPECIFICATIONS:

TYPE:	SURFACE MOUNTED/PENDANT
VOLTAGE:	120V
WATTAGE:	15/20//30/40/50/60/90W
OUTPUT LUMEN:	80LM/W
UGR	<12
CCT:	2700K/3000K/4000K/5000K
BEAM ANGLE:	20°/40°
SWIVELING	NO
CRI:	90/95
DIMMABLE:	YES
HOUSING COLOR	BLACK/WHITE
REFLECTOR COLOR	BLACK/WHITE/SILVER
IP:	65
LIFE SPAN:	50000 HOURS

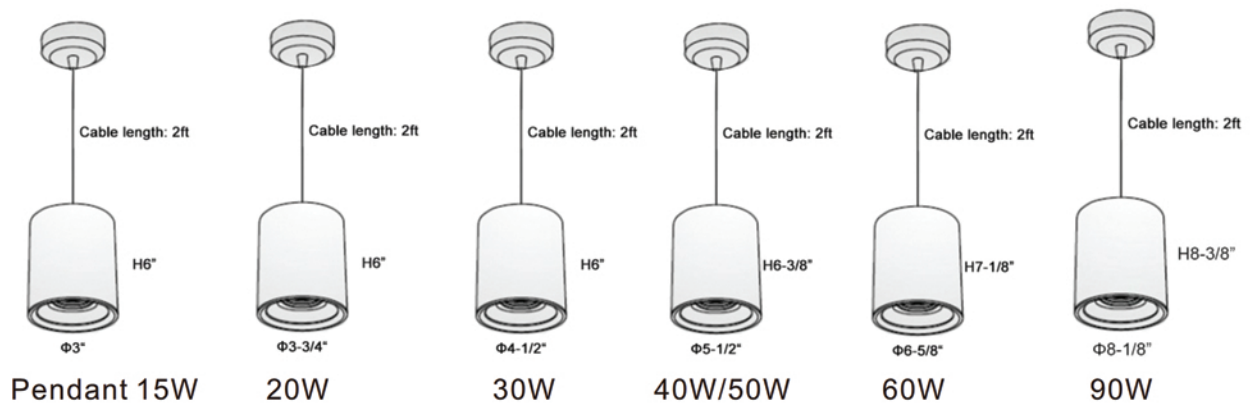

3740 William St, Burnaby, BC V5C 3H7
 Phone: +1 (604) 294-2334, Toll free: +1 (877) 294-2334, Fax: +1 (604) 294-2126
 www.premierlight.ca

PROMAX AQUATIC
 LAST UPDATE: JULY, 2023
 PAGE 1 of 2

APPLICATIONS:

PENDANT OR SURFACE MOUNTED DOWNLIGHT, SUITABLE FOR WET LOCATIONS, INCLUDING BUT NOT LIMITED TO BATROOMS, OUTDOOR CANOPY, RAILWAY STATION, AIRPORT, AND HOTEL ENTRANCES.

ETL CERTIFIED, FIVE YEARS WARRANTY.

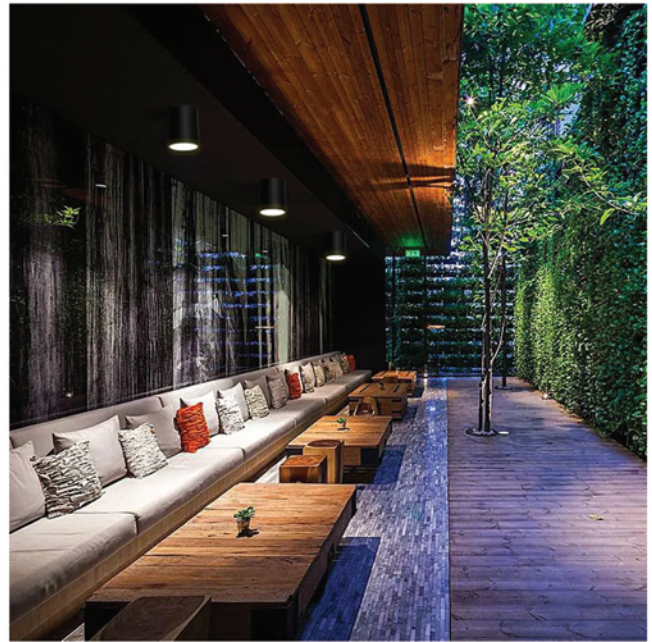

ORDERING INFORMATION:

EXAMPLE: PM-AQUATIC-P-15-2700-20-90-T-B-B

SERIES	TYPE	WATTS	COLOR TEMP.	BEAM ANGLE	CRI	DIMMING	FRAME COLOR	REFLECTOR COLOR
PM-AQUATIC	P: Pendant	15	2700	20	90	T: Triac	W: White	W: White
	S: Surface Mounted	20	3000	40	95	V: 0-10V	B: Black	B: Black
		30	4000			D: Dali		S: Silver
		40	5000					
		50						
		60						
		90						

80 lm/W, 120VAC