

LUMEO-R5



Remodel



New Construction



LAMP HOUSING

OPTICS	120°
TRIM	Super Slim/Thin Flat Design
MATERIAL	Die-casting Proceed ADC12

LED LIGHT ENGINE

RATED WATTAGE	10W
DELIVERED LUMENS	Up to 850 lm (based on 85lm/w output)
EFFICACY	85lm/w (100-110lm/w can be customized)
CCT @ 90CRI	2700K,3000K,3500K,4000K,5000K,6000K, 5CCT, Warm Dim
COLOR QUALITY	CRI85+,3-Step SDCM
LED LIFETIME	50,000 hours

POWER SUPPLY

INPUT VOLTAGE	120Vac/120-277Vac/100-347Vac,50/60Hz
DIMMING	TRIAC/ELV/0-10V/Dali Dim
SERVICABILITY	Below Ceiling Access

TRIM OPTIONS



Flat



Regress Baffle



Regress Bevel

TRIM COLORS



Matt White



Matt Black



Matt Silver



Brush Nickel

FEATURES

- .Super Thin Flat design
- .Easy and quick installation
- .IC Airtight for use with direct contact to insulation.
- .Eliminates the need for housing. .
- .New Construction application requires mounting plate or frame.
- .Remodel applications require no additional accessories.
- .Suitable for Damp Location allows for use indoor residential and commercial areas.
- .Includes driver and J-box which can fit up to 6x AWG14 cable wires ..

INSTALLATION

- .Recessed
- .Insulated/drop ceilings
- .Fits under studs and in narrow plenums

DIMENSIONS

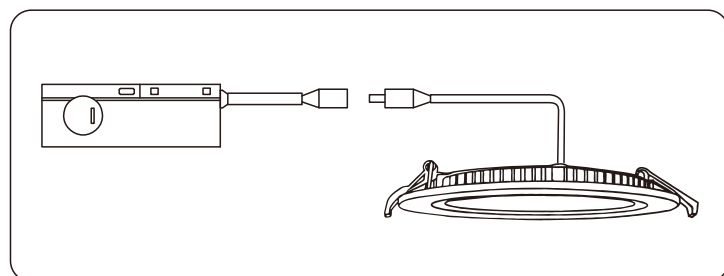
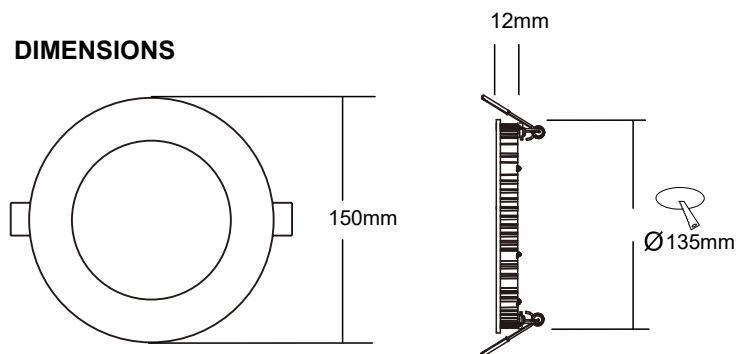

LUMEO-R5



ASSESSORY AVAILABLE

Push-in Connector-1/2" Trade Size NM cable



LUMEO-R5-NM1



LUMEO-R5-NM2

Clamp Connector-1/2" Trade Size NM cable



LUMEO R5-NM3

Extension Cable-2Pin



LUMEO-R5-FLEX6 (6ft)
LUMEO-R5-FLEX10 (10ft)
LUMEO-R5-FLEX20 (20ft)

Extension Cable-3Pin



LUMEO-R5-FLEX63 (6ft)
LUMEO-R5-FLEX103 (10ft)
LUMEO-R5-FLEX203 (20ft)

RIP With bars

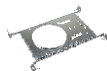

LUMEO-R5-RIP-Bar

Rough In Plate

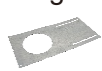

LUMEO-R5-RIP

DESCRIPTION	CHARAMETERS
Watt	5W/7W/9W/10W
Color temperature	1CCT, 5CCT, DIM-TO-WARM
CRI	85+
Lumens/Watt	85+
Ambient Temperature	-40°C to +40°C (-4 °F-104°F)
Input voltage	120V / 100-277V/100-347V
Input frequency	50/60 Hz
Dimmable	Triac/ELV/0-10V/Dali Dimming
Approved Location	Insulated ceiling, Damp
Benefits	Type IC rated
Trim Finish	Powder Coated In Colors
Project Lifespan	70% light output at 50,000 hours
Certificate	cETLus(Confms to CSA&UL Standards)
Limited Warranty	2 Years

Order Matrix 1

5" NEW CONSTRUCTION / REMODEL(STANDARD: LUMEO-R5-RM-09-SV5C-WHT)

Series	Installation Type	Wattage	Lumen	Driver	CCT / CRI	FINISH	
LUMEO-R5	NC New Construction RM Remodel	-05 (5W) -07 (7W) -09 (9W) -10 (10W)	425lm 595lm 765lm 850lm	SV Single-Volt -120Vac (Triac /ELV Dim,5%-100%)	27 (2700K/85CRI) 30 (3000K/85CRI) 35 (3500K/85CRI) 40 (4000K/85CRI) 50 (5000K/85CRI) 60 (6000K/85CRI) 65 (6500K/85CRI) 5C (27K-30K-35K-40K-50K) 5C1 (27K-30K-40K-50K-60K) WD* (1800K-3000K)	WHT (Matt White) BLK (Matt Black) SLV (Matt Silver) BN (Brush Nickel)	
				MV1 Multi-Volt -120-277Vac (0-10V Dim,5%-100%)			
				MV2 Multi-Volt -120-347Vac (0-10V Dim,5%-100%)			
				DALI Multi-Volt -120-277Vac (DALI Dim,5%-100%)			
				WIFI Multi-Volt -120-277Vac (Tuya App-Smart dimming)			
				ZIGBEE Multi-Volt -120-277Vac (Tuya App-Smart dimming)			
				POE Rj45 connector (customized by customer's control sys.)			
				*Note: EM Backup is pending			

1: Special specifications and made-to-order options require a minimum order quantity

LUMEO-R5



PHOTOELECTRICITY

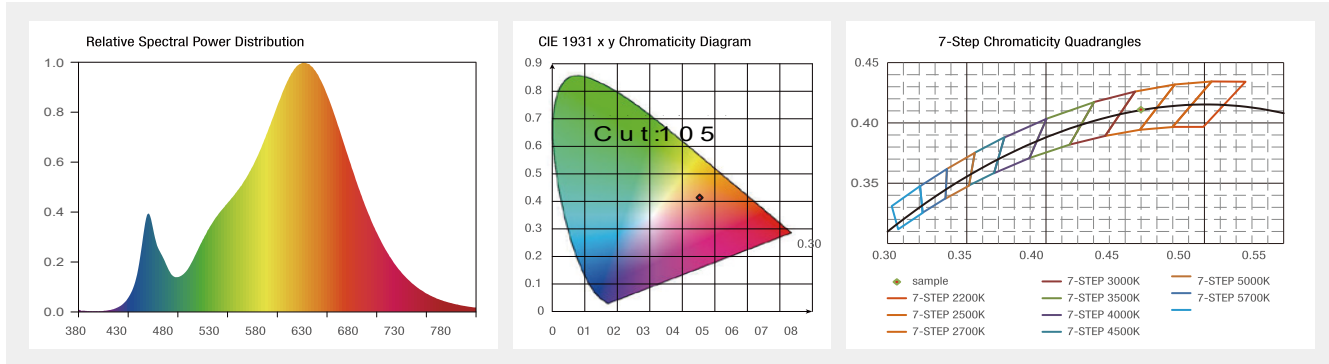

ASSEMBLY INSTRUCTIONS:

Fig.1

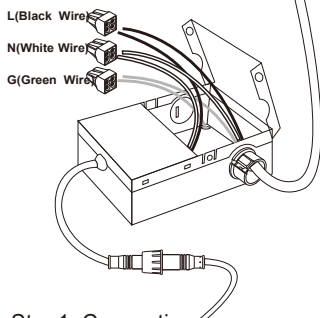

Step1: Connecting

Using wire nuts, connect green ground wire of cable to green wire on box. Connect white wire of cable to white of box. Connect black wire of cable to black wire of box.

Fig.2

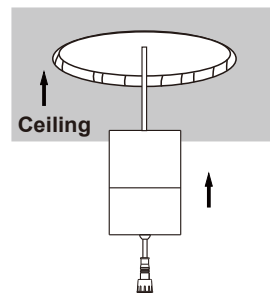

Step2: Inserting

Insert hardware box through the mounting hole.

Fig.3

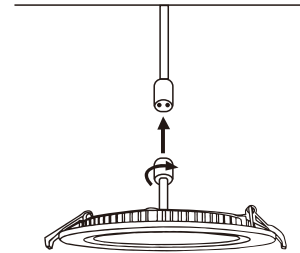

Step3: Twisting

Connect the fixture to the hardware box by inserting and twisting the male/female connectors.

Fig. 4

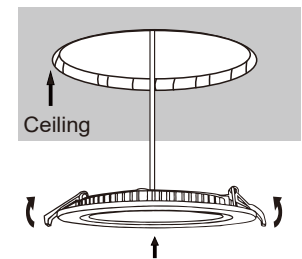

Step4: Pushing

Push spring loaded clips on the fixture upwards and insert fixture base in to the mounting hole. Release the clips and fixture will be pulled flush to the ceiling.

STOP READ ENTIRE INSTALLATION PROCEDURE BEFORE YOU BEGIN!

⚠ WARNINGS AND CAUTIONS

SHUT OFF POWER AT THE CIRCUIT BREAKER OR FUSE PANEL BEFORE REMOVING THE OLD FIXTURE AND/OR INSTALLING A NEW ONE.

Read entire installation procedure before you begin and save instructions for future reference.

If unsure whether the electrical box is properly grounded, or the box is plastic and has no ground wire, or are unfamiliar with the methods of properly grounding fixture, consult a qualified electrician.

RISK OF ELECTRIC SHOCK

- Turn power off before inspection, installation or removal.
- Properly ground electrical enclosure.

RISK OF FIRE

- Follow all NEC and local codes.
- Use only UL or IEC approved wire for input/output connections. Minimum size 12 AWG (2.5mm).



Electrical Requirements

- The LED luminaire must be connected to the mains supply according to its ratings on the product label.



Grounding Instructions

- The grounding and bonding of the overall system shall be done in accordance to local electric code of the country where the luminaire is installed.

Important Safety Information

- Suitable for **INDOOR** damp locations.
- Do not look directly at LEDs for extended period of time.
- Turn power off before servicing.
- Do not leave bare wires exposed.
- Use Minimum 90°C supply conductors. For additional electrical requirements, see fixture.